

### CAUTION RISK OF INJURY!

Understand these instructions prior to using product

**VERTICAL LOAD BEARING ONLY** - Product intended for moderate VERTICAL weight bearing on rail only. - DO NOT use if sideward (lateral) support is needed..

**AVOID RAIL LATCH UNLOCKING** - Ensure that rail is at least 2"/50mm off floor when rail is in locked position. (Soft type box spring beds can compress downward under load allowing support frame to move down, and rail to become unlatched)

Maximum user weight 250lbs/113kg

Do not use on wet or slippery floors

Do not use with electric or hospital style beds.

Both supplied straps must be installed for secure operation

Product intended for moderate assist with sitting up and standing only.

### 1 Insert Support Frame

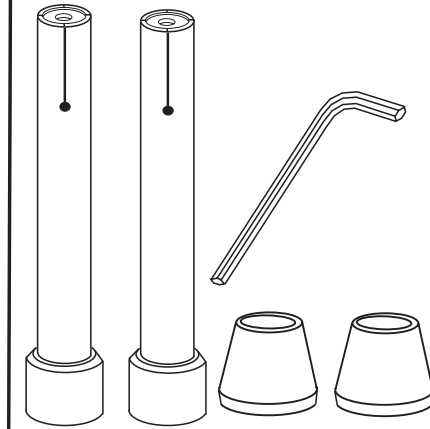

### 2

### Insert 1st Leg Extender

Insert Rail in guide tube on SmartRail face plate, insert leg Extenders piece into this rail to desired height. Tighten screw at bottom of leg extender piece with allen wrench provided.

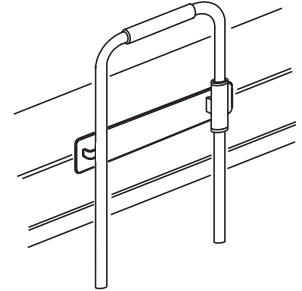

### 3 Insert SafeLatch Collar

(with rail at correct height turn set screw until collar is tight on rail)

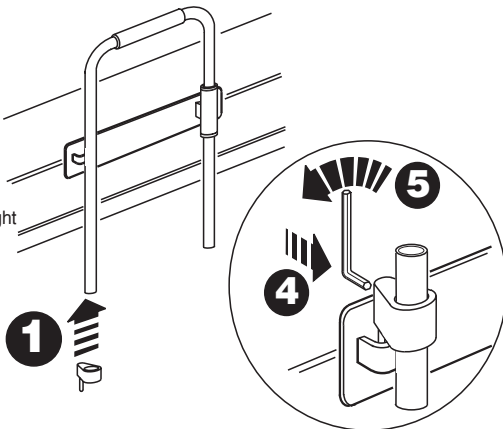

### 4

### Insert 2nd Leg Extender

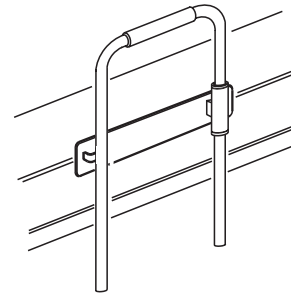

### 5

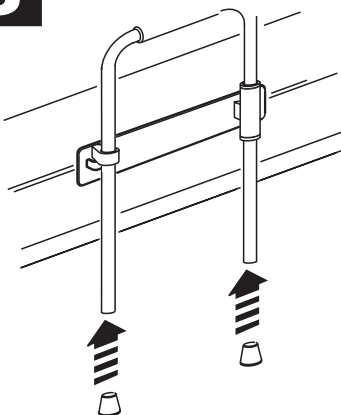

Install rubber cane tips

## SUGGESTIONS...



**LOCKED RAIL** - grab onto grip, or leg of rail to help with moving in bed and sitting up at side of bed -

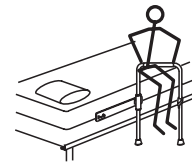

**HINT** - grab the rail closest to the pivot leg for most easy lifting. Pivot rail and place in an appropriate location as shown.

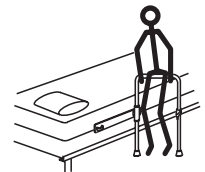

**STANDING** - Use rail to help with standing up from bed -  
**NOTE** - rail is meant to provide support for vertical weight bearing only.